

F2/FT2 OFFSET PIVOT DOORFRAME for SURFACE CLOSER

SERIES CF450 DOORFRAME

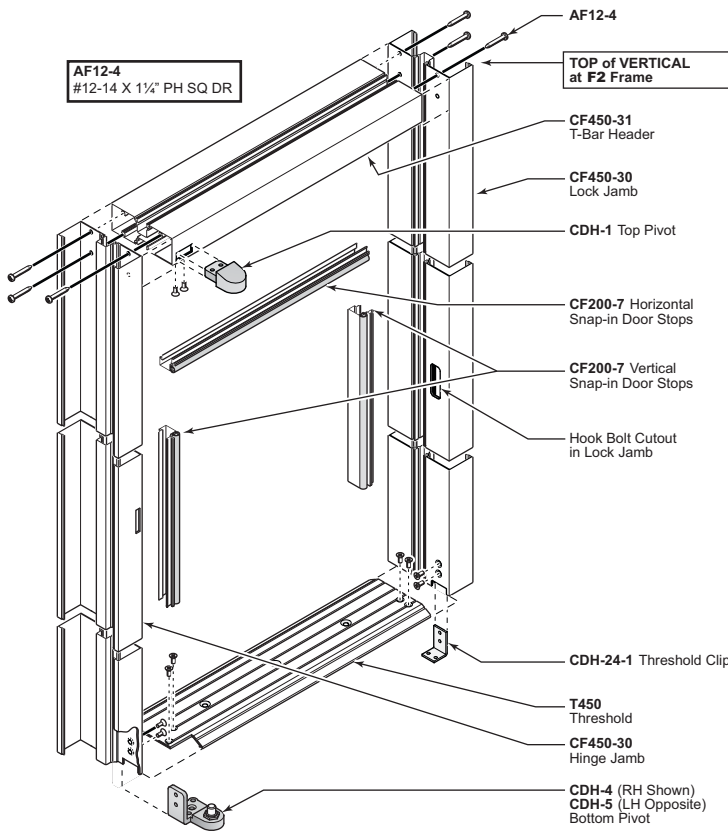

OFFSET PIVOT DOOR

ENTRANCE DOORS

ASSEMBLY INSTRUCTIONS:

1. Verify opening size. Allow 3/8" shim and caulk space at wall jambs and top of frame.
2. For transom frames, cut off the top of vertical jambs above transom bar as required.
3. Drill holes at top of transom frame for the transom head.
4. Reference **Series 450 or Series 451 Installation Instructions** for joint seal applications.
5. Assemble threshold, transom bar and transom head (for transom frames) as shown in the exploded view and detail drawings.

INSTALLATION INSTRUCTIONS:

1. Set doorframe into opening plumb and square.
2. Drill holes in vertical door jambs and transom bar (or transom head) and anchor as shown in the **Series 450/Series 451 Installation Instruction** anchor charts based on wind load and substrate requirement.
3. Snap-in or apply door stops to conceal anchor attachment screws.
4. Install setting blocks in transom bar at 1/4 or 1/8 points as required and glaze transom as shown using the ABC's for glazing located in the **CF450/CF451 Installation Instructions**.
5. Install glazing bead(s) in transom where required.
6. Roll-in **GSK-1** top load gasket in transom.

NOTE:
Your door might have a different hinge direction than shown

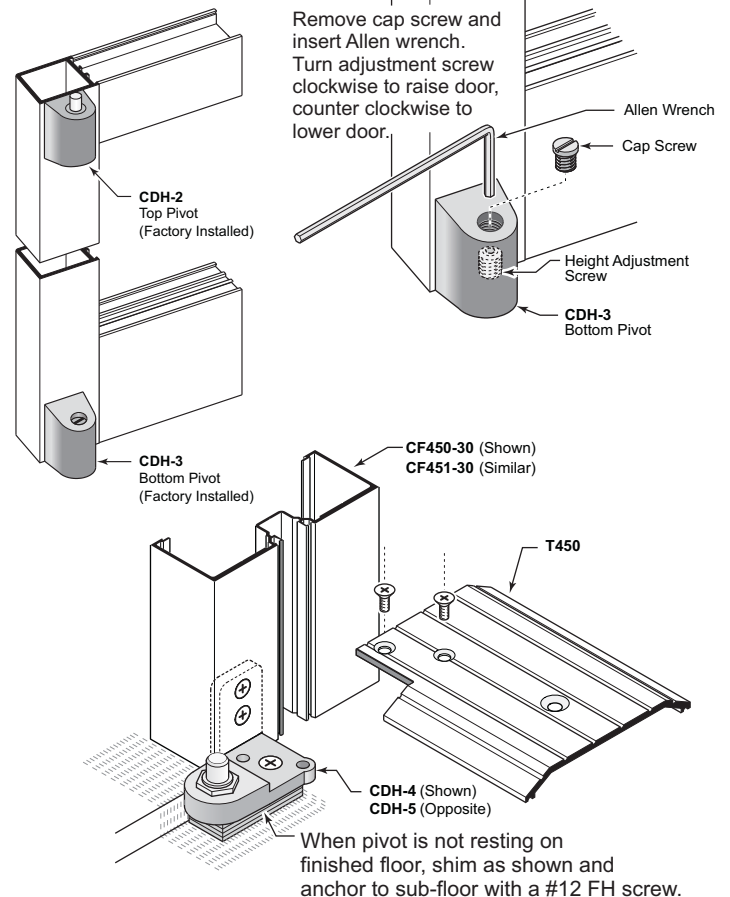
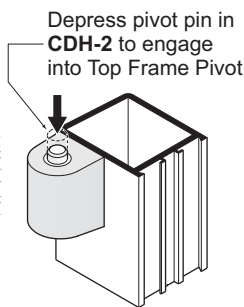
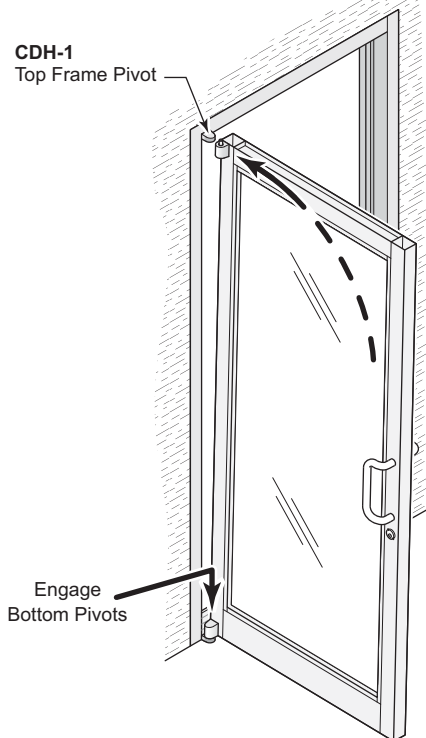

OFFSET PIVOT DOOR INSTALLATION

PERIMETER ANCHORING SUBSTRATES



0 - 20 PSF INTO CONCRETE SUBSTRATE

FASTENER LEGEND for 3,000 PSI CONCRETE SUBSTRATE	
■	= 1/4" Tapcon 1 3/4" Minimum Embedment, 1 1/2" Minimum Edge Distance, with filler plate full length of mullion.
▲	= 1/4" Tapcon 1 3/4" Minimum Embedment, 1 1/2" Minimum Edge Distance.

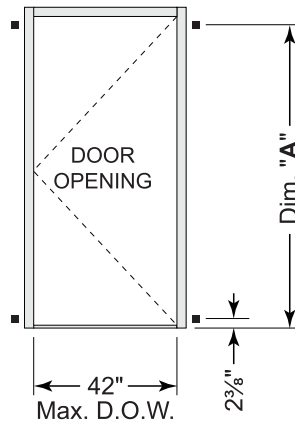

0 - 20 PSF INTO WOOD SUBSTRATE

FASTENER LEGEND for #2 S.Y.P. WOOD SUBSTRATE	
■	= 1/4" Lag Bolts 2 1/2" Minimum Embedment with filler plate full length of mullion. 1 1/2" Minimum Spacing.
▲	= 1/4" Lag Bolts 2 1/2" Minimum Embedment. 1 1/2" Minimum Spacing.
◆	= #14 Wood Screws 2 1/2" Minimum Embedment.

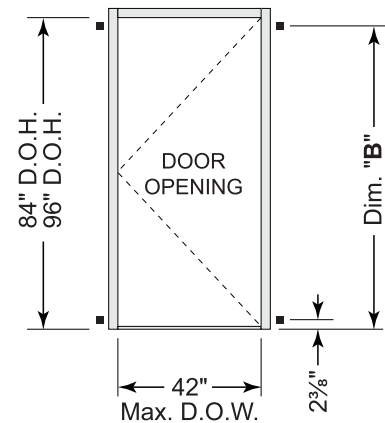

0 - 20 PSF INTO STEEL SUBSTRATE

FASTENER LEGEND for STEEL SUBSTRATE - FY = 36 KSI Min.	
■	= 1/4" Tek Anchor with filler plate full length of mullion.
▲	= 1/4" Tek Anchor

